

# WAVERLEY GROVE

SOUTHSEA | PO4 0PZ



£185,000  
Leasehold

- First Floor Flat In Central Location
- Two Bedrooms
- Bath & Separate W.C.
- Beech Effect Kitchen
- Easy Access To The Beach
- Gas Central Heating
- Secure Entry
- Chain Free Sale



### In Brief

An opportunity to own a first floor, two-bedroom apartment set in an older, character building.

Offered for sale chain free, the accommodation briefly comprises of spacious living room, large master plus second bedroom, bathroom and separate W.C. and galley kitchen measuring over 13' in length.

£185,000

### KEY FACTS

TENURE: Leasehold  
EPC RATING: D  
COUNCIL TAX BAND : A  
SERVICE CHARGE: £600 p.a.  
GROUND RENT: Nil  
LEASE LENGTH: 994 Years







### First Floor

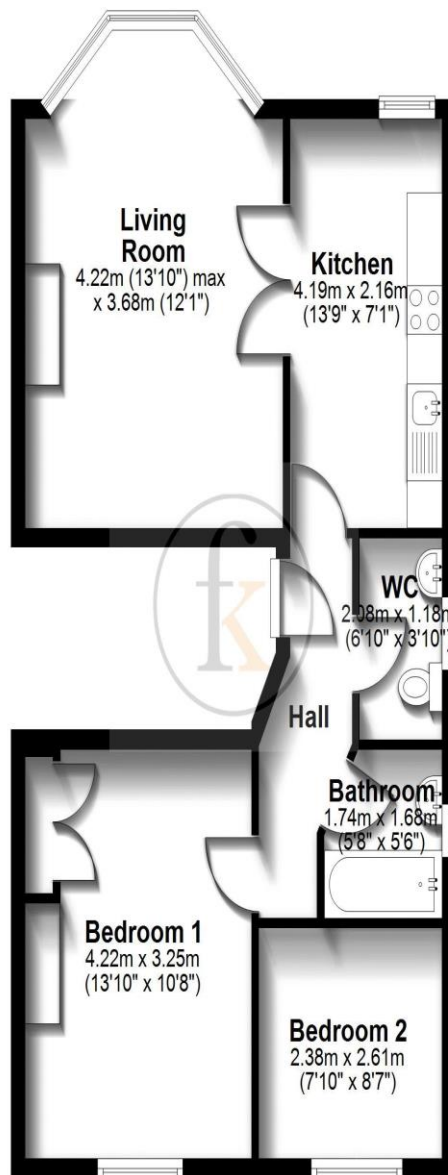

These plans are for illustrative purposes only and while we take every care to confirm their accuracy, they must not be relied upon as a definitive representation of the subject property.  
Plan produced using PlanUp.

### Flat C, 3 Waverley Grove, Southsea

**Southsea**  
Sales & Lettings  
7/9 Stanley Street,  
Southsea, PO5 2DS  
Tel: 023 9281 5221

**Old Portsmouth & Gunwharf Quays**  
Sales & Lettings  
The Seagull, 13 Broad Street,  
Old Portsmouth, PO1 2JD  
Tel: 023 9281 5221

**Drayton & Out of Town**  
Sales & Lettings  
139 Havant Road,  
Drayton, PO6 2AA  
Tel: 023 9221 0101

**London**  
Sales & Lettings  
Mayfair Office, Cashel House,  
15 Thayer Street, W1U 3JT  
Tel: 0870 112 7099

**Southsea**  
Admin Centre  
12 Marmion Road,  
Southsea, PO5 2BA  
Tel: 023 9282 2300

[www.fryandkent.com](http://www.fryandkent.com)